

Mystery Grid

Draw the individual squares in the appropriate spaces to reassemble the image.

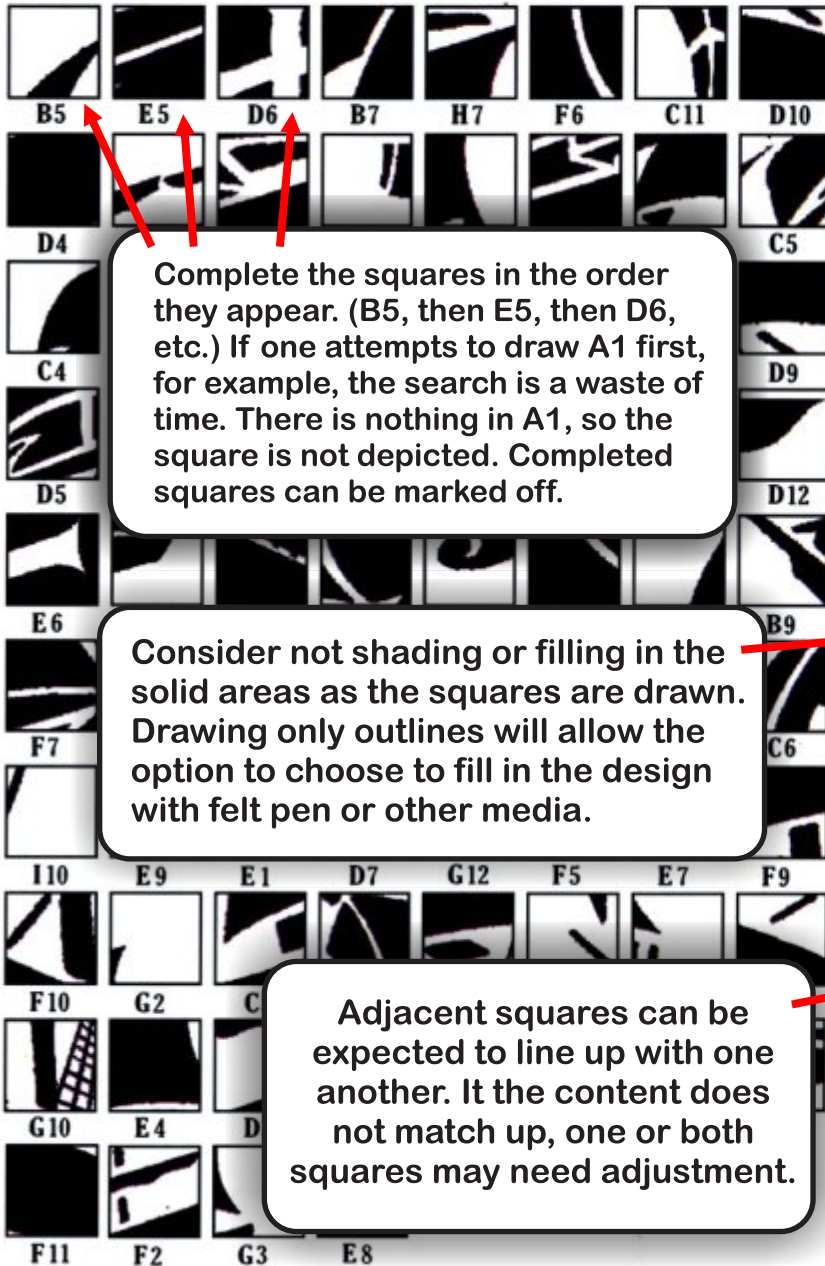

Complete the squares in the order they appear. (B5, then E5, then D6, etc.) If one attempts to draw A1 first, for example, the search is a waste of time. There is nothing in A1, so the square is not depicted. Completed squares can be marked off.

Consider not shading or filling in the solid areas as the squares are drawn. Drawing only outlines will allow the option to choose to fill in the design with felt pen or other media.

Adjacent squares can be expected to line up with one another. If the content does not match up, one or both squares may need adjustment.

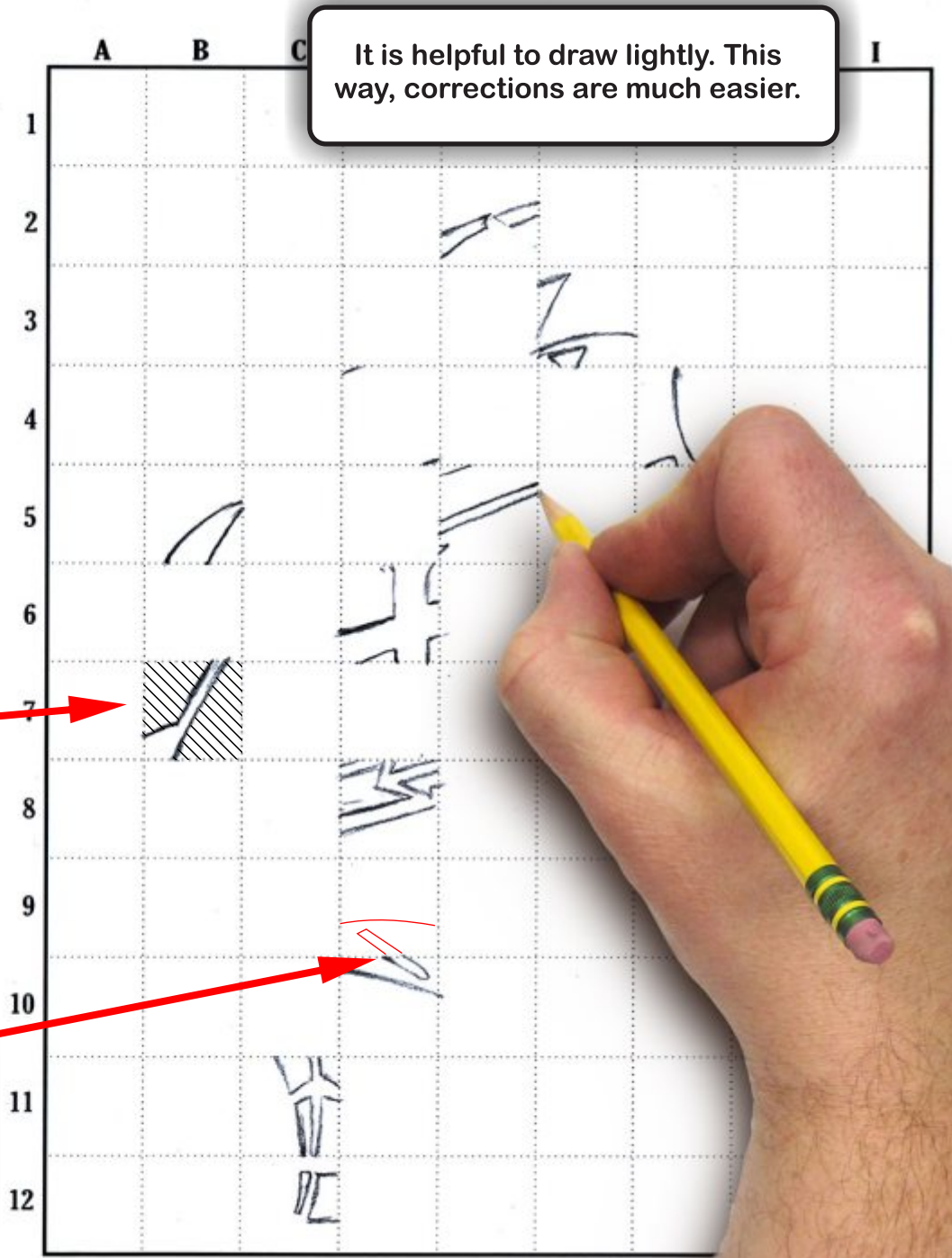

It is helpful to draw lightly. This way, corrections are much easier.

Blank grids are provided for convenience. Creating one's own blank grid or drawing lines in the premarked grid blanks allows for the possibility to remove the grid from the drawing when complete.

Using light pressure in pencil as one draws the individual squares allows easy erasing and adjustment. This will also provide for more options later to apply color and other media.

